

Seznam souřadnic (S-JTSK):

Souřadnice pro zápis do KN				Souřadnice určené měřením	
Číslo bodu	Y	X	kk	Y	X
1692-26	748635.52	1036414.79	8	748635.59	1036415.40
1692-27	748746.30	1036405.26	3		
1692-41	748847.42	1036343.87	3		
1692-79	748746.16	1036405.98	3		
1692-80	748746.59	1036405.54	3		
1692-279	748847.81	1036343.66	3		
1692-638	748634.86	1036414.86	8		
20	748846.59	1036344.32	3		
21	748846.74	1036344.70	8		
22	748847.51	1036344.30	8		
31	748810.16	1036367.04	3		
32	748810.11	1036367.48	8		
33	748748.60	1036405.91	8		
34	748640.56	1036414.30	3		
35	748640.64	1036414.90	3		
36	748635.72	1036414.65	8	748635.78	1036415.21
37	748638.10	1036414.60	3		
38	748635.78	1036415.24	8	748635.84	1036415.81
39	748638.20	1036415.20	3		
40	748630.86	1036414.13	8	748630.52	1036414.70
41	748632.26	1036414.41	3		
42	748635.15	1036414.19	3		
43	748635.46	1036414.51	3		
44	748810.56	1036366.78	3		
45	748810.24	1036366.36	3		
46	748847.47	1036343.98	3		
47	748847.45	1036343.36	3		
48	748846.89	1036343.51	3		
49	748846.75	1036344.26	3		
50	748748.83	1036405.30	8		
51	748673.15	1036375.92	8	748672.94	1036377.52
52	748660.05	1036378.57	3		
53	748654.71	1036379.32	3		
54	748643.92	1036380.44	3		
55	748809.60	1036366.62	3		
56	748809.50	1036367.49	3		
57	748809.52	1036367.63	8		
58	748632.34	1036415.01	3		
59	748673.16	1036376.52	8	748672.97	1036378.12
60	748660.11	1036379.17	3		
61	748654.81	1036379.92	3		
62	748643.99	1036381.04	3		
63	748634.91	1036414.81	3		
64	748630.94	1036414.72	8	748630.56	1036415.29

Souřadnice bodů na dosavadní hranici pozemku určené měřením v terénu budou pro zápis do katastru nemovitostí upraveny podle dosavadního určení hranice lomovými body s kódem charakteristiky kvality souřadnic vyšším než 3. Důvodem je nerealizované zpřesnění této hranice, ke kterému je nutné doložit listinu prokazující shodu vlastníků na jejím průběhu (§ 50 odst. 1 písm. a) katastrálního zákona).

Přehled kladu listů

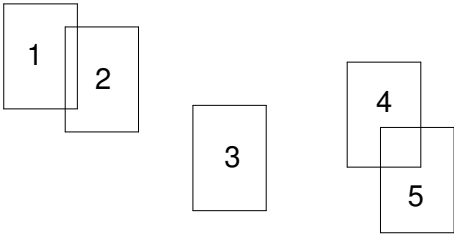

290/12

379

296/10

Det.A

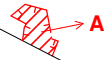

296/7

911

193

296/11

296/6

Q
290/12



Q
296/2

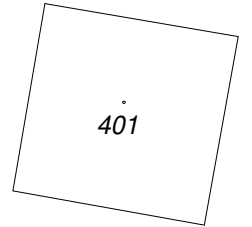

Q
296/3

379

Q
296/6

II
296/5

B  Det.B

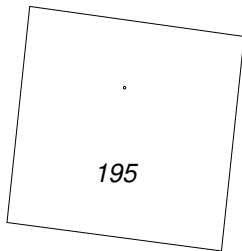

II
296/4

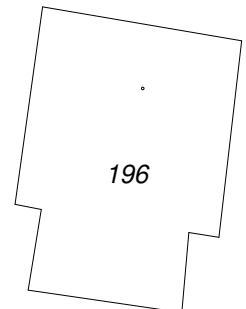

Q
596

Q
597

602

Q
626

Q
603

Q
627

726

609

610

50 (2.53) (0.40) 1692-27
33 (2.44) 1692-80 (0.62) 1692-79

Q
619

625

Q
628

727

747

Q
630

3

Q
599

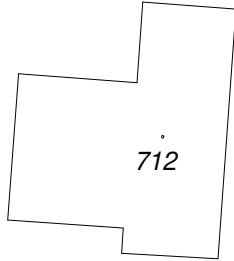

712

Q
598

Q
600

Q
601

51

59

(13.37)

52

(5.39)

53

(10.85)

54

(13.32)

60

(5.35)

61

(10.88)

62

(0.60)

Q
604

Q
605

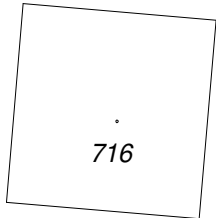

716

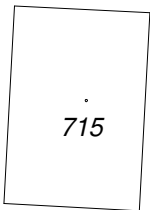

715

Q
606

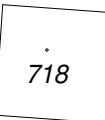

718

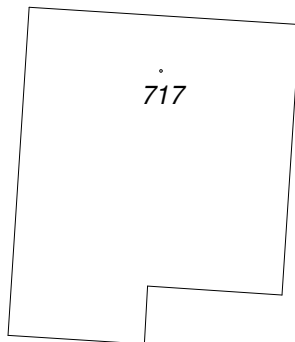

717

Q
607

Q
605

Q
606

718

Q
607

Q
608

717

719

614

615

616

635

618

(0.61) 34 (2.48) 37
35 (2.46) 39 41 (1.43) 40
58 (1.43) 64

Det.C

Q
623

617

Q
624

723

724

Det.A

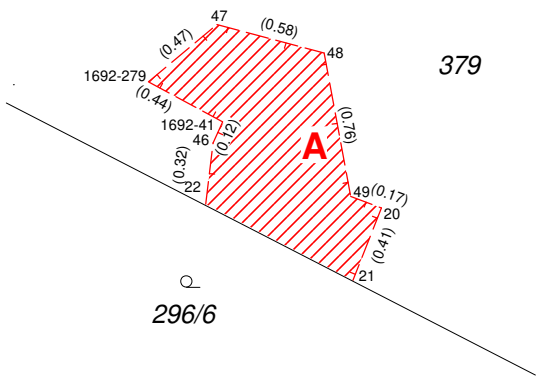

Det.B

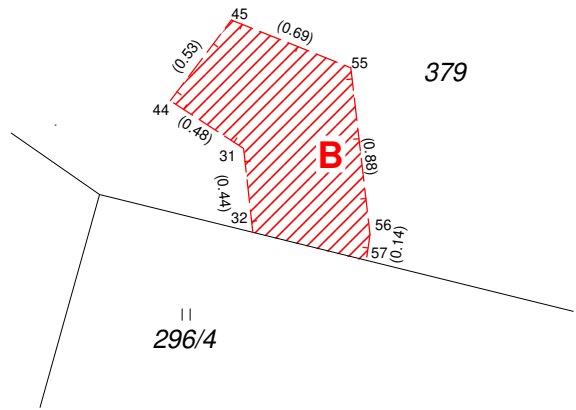

Det.C

